



ZETA Mouseholes

ZETA MOUSEHOLES

Cleanroom pass-through system for hoses ensures a safe medium transfer

A particular challenge when routing hoses for single-use systems is their passage through cleanroom walls. The ZETA Mouseholes ensure that the different pressure levels of the respective cleanroom classes are maintained. At the same time, the wall ducts meet all requirements for aseptic process control.

The ZETA Mouseholes consist of a surface-flush stainless-steel panel with welded-in stainless steel tubes. They allow passing-through of hoses with SU connectors or ZETA Sterile Connectors fitted. It is also possible to pass through sealed hoses without attached connectors. Closing is achieved via the installation of EPDM half-shells on both sides, secured with TC clamps. The half-shells can be customized and individually adapted to the desired tubing diameters.

If a pass-through is not required, it can be closed with a supplied blanking plug.

All removable parts can be sterilized or prepared for use by wipe disinfection. The easy-to-use passing-throughs for hoses ensure maximum operator safety and process reliability.



Individual components of ZETA Mouseholes

Technical data for ZETA Mouseholes:

| | |
|-----------------------------------|--|
| Materials | Stainless steel: 1.4301 Gasket: EPDM |
| Roughness | Ra < 1,2 µm |
| Wall thickness | 50-70mm 80-100mm |
| TC Connection diameter | DN 100 |
| Inner diameter | 110mm |
| Inner space (inner length) | 110-160mm |
| Gasket models | Split version for hoses with connectors Full version for hoses only |



Gasket set with clamp



Wall installation parts

Standard model:

To prepare the hose pass-through, the ZETA Mouseholes are opened at one side - the other side remains closed. Next, the connector with hose is inserted, and the gasket is installed around the hose. To fix the hose and the gasket, the clamp is attached. Now the ZETA Mouseholes are opened at the other side, and the hose is pulled through the opening with the connector. Finally, the second side is also closed with the gasket set and the transfer line is ready to use.



STEP 1
Open clamp



STEP 2
Insert hose and mount gasket at first side

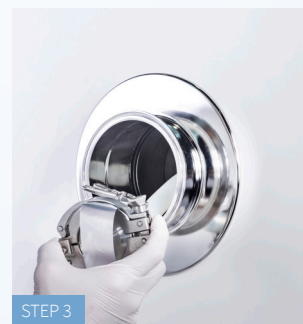

STEP 3
Pull through hose



STEP 4
Close system with gasket and clamp

Benefits at a glance:

- ▶ Easy assembly
- ▶ Suitable for multiple hoses
- ▶ Universally usable
- ▶ Process reliable